

# SNOWSOUND<sup>®</sup>

Acoustic Technology & Design



# Research & Patents

Snowsound technologies and products are covered by a variety of patents, the result of intensive research and development that is still in progress, partly due to our ongoing partnerships with universities and research institutions.



# Snowsound Software

## Hear and Experience the Difference

The Snowsound acoustic calculation software, which won international awards and is valued by industry professionals for its precision, reliability and ease of use, with the 2.0 release is even more comprehensive with a powerful sound algorithm that allows the sound of a room to be heard before and after the treatment with Snowsound products. Snowsound software can simulate a room's acoustic footprint, while accounting for the performance of the materials at the various frequencies and recreate the reverberation effect between 63 and 8000 HZ, a detail that until now has been reserved for the most refined ray tracing software. After the usual data entry processes, Snowsound software not only demonstrates the curves post and preinstallations, it also generates acoustic files that simulate the environment before and after installing Snowsound products. All that's left is to grab some earbuds or a headset and listen to the amazing effect of Snowsound technologies.

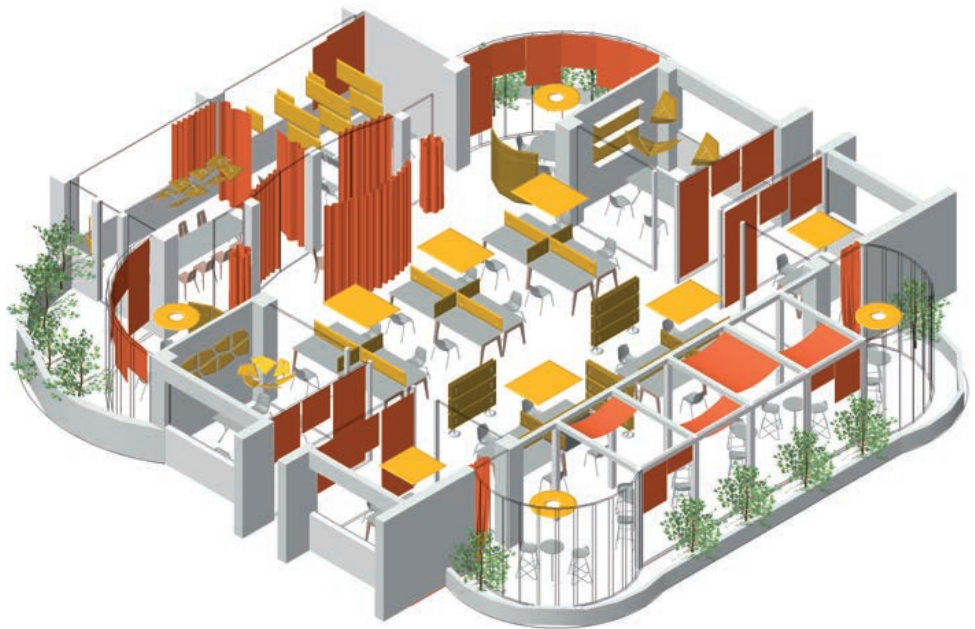
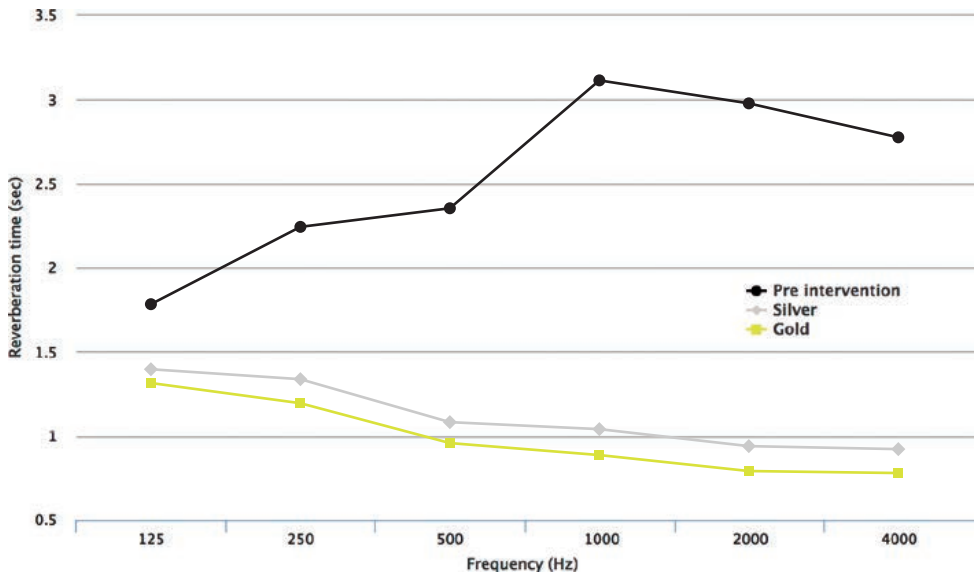

Best of NeoCon (U.S.A.)



German Design Award (Germany)

# Snowsound Technology

## Design and Designers

- Gillo Dorfles
- Sezgin Aksu
- Lorenzo Damiani
- Michele De Lucchi
- Alberto Meda & Francesco Meda
- Lorenzo Palmeri
- Marc Sadler
- Mario Trimarchi
- Snowsoud Lab

## Research and Patents

### “A” Class

UNI EN ISO 354 (UNI EN ISO 11654) and ASTM C423

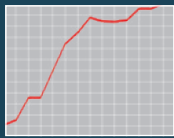

## Decibels’ Reduction

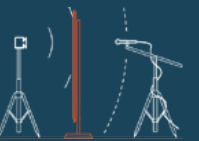

## Sound Quality

UNI EN ISO 10534-2

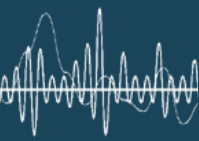

## 100% Sound Absorbing



## Strong, Light and Thin



## Greenguard Gold and UL Spot

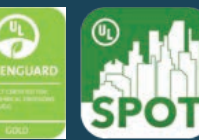

## Eco-Friendly

100% Recyclable



## No Formaldehyde

UNI EN 717-2



## Hygiene & Maintenance



## CE

EN 13964 - Regulation (UE) no. 305/2011



## Fire

Class A Flame Spread and Smoke Development  
UL 723, ASTM E84



## Extreme Conditions

ISO 9142



The brilliant intuition at the heart of Snowsound patented technology is based on the use of panels composed of material with variable density, which achieve selective absorption at different frequencies and thus optimize the acoustical environment notwithstanding the thinness of the panels. The absence of frames and seams and the unusual characteristics of the material used in the fabrication of the panels, render them extremely light, unobtrusive and adaptable to any environment.

1

The surfaces of the panel is coated with Trevira CS® polyester fabric firmly bonded to the inner wadding with which it forms a single body without a break. This property makes it possible to obtain a surface which, while visually appearing very soft, actually is resistant, difficult to tear or perforate.

2

High density polyester.

3

Medium density polyester.

4

Low density polyester.

5

Rigid edge.

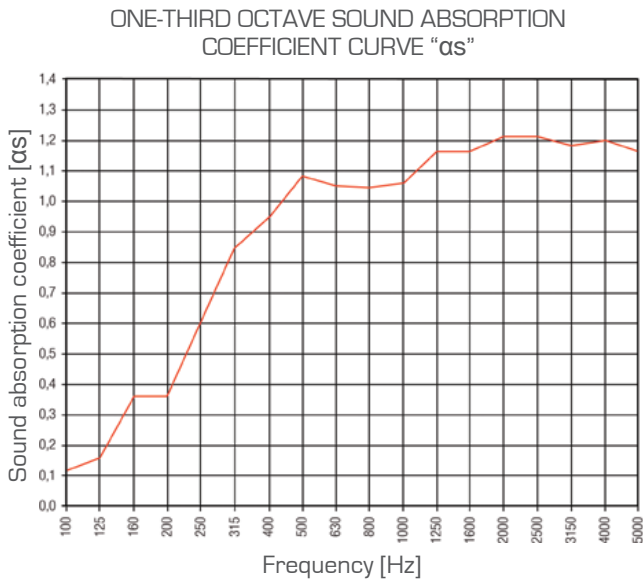
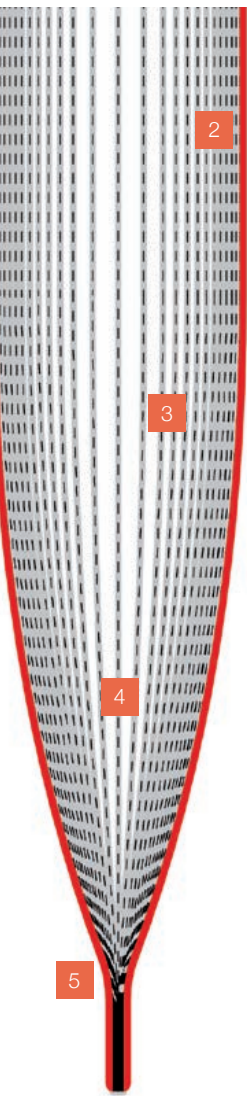



# Snowsound Technology Panel Collection

Design Mario Trimarchi



Botanica

Design Alberto & Francesco Meda



Flat

Design Snowsound Lab



Snowfix

Design Michele De Lucchi



Mitesco

Design Marc Sadler



Tra Light

Design Snowsound Lab



Minimal

Design Snowsound Lab



Oversize Wall

Design Snowsound Lab & Marc Sadler



Oversize Ceiling/Lux

Design Lorenzo Damiani



Blade

Design Marc Sadler



Corner

Design Snowsound Lab



Snowfront

Design Snowsound Lab



Oversize Desk

Design Marc Sadler



Baffle

Design Marc Sadler



Baffle Oversize

Design Snowsound Lab

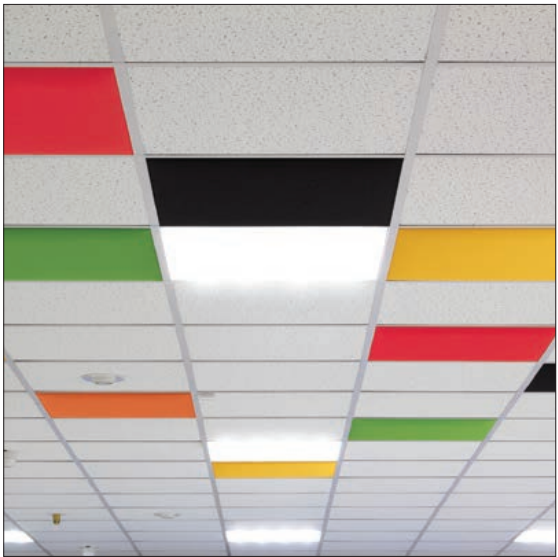

In

Design Marc Sadler



Pli Over

Design Marc Sadler



Pli

Design Marc Sadler



Pli Oversize

Design Alberto & Francesco Meda



Flap

Design Alberto & Francesco Meda

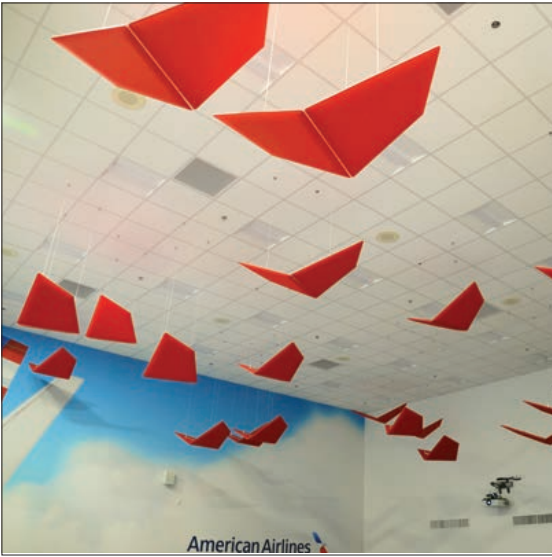

Flap Wings

Design Alberto & Francesco Meda



Flap Chandelier/Chain

Design Sezgin Aksu



Giotto Wall

Design Sezgin Aksu



Giotto Ceiling/Lux

Design Gillo Dorfles



Snowsound Art



# Snowsound Fiber Products

## Design and Designers

- Sezgin Aksu
- Atelier Mendini
- Moreno Ferrari
- Alberto Meda & Francesco Meda
- Annalisa Dominoni & Benedetto Quaquaro

## Research and Patents



## Acoustic Performance

UNI EN ISO 354  
[UNI EN ISO 11654]  
and ASTM C423

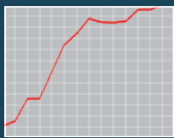

## Greenguard Gold and UL Spot



## Eco-Friendly

100% Recyclable



## No Formaldehyde

No Formaldehyde  
UNI EN 717-2



## Fire

Class A Flame Spread  
and Smoke Development  
UL 723, ASTM E84



The patented Snowsound Fiber technology is based on soft interwoven polyester acoustic fibers that are inherently fire-resistant. The interaction between the special acoustic fibers and the design of the objects and the support systems help reduce annoying acoustic reverberation in rooms, while improving quality both of life and of work.

- 01 **Fiber 3** - Clasp Divider
- 02 **Fiber 3** - Sepa
- 03 **Fiber 6** - Diesis
- 04 **Fiber 6** - Si Sboccia



# Snowsound Fiber Products

Design  
Atelier Mendini



Diesis

Design  
Atelier Mendini

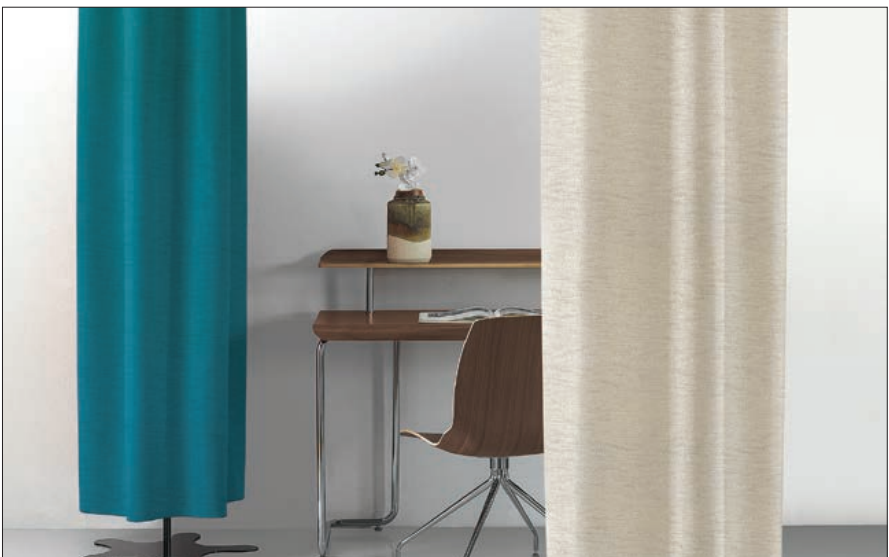

Diesis

Design  
Atelier Mendini



Bemolle

Design  
Atelier Mendini



Bemolle

Design  
Moreno Ferrari



Si Sboccia

Design  
Annalisa Dominoni & Benedetto Quaquaro



Clasp Wall

Design  
Annalisa Dominoni & Benedetto Quaquaro



Clasp Divider

Design  
Sezgin Aksu



Sepa/Sepa Rolls



# Snowsound Fiber Textiles

The patented Snowsound Fiber technology is based on soft interwoven polyester acoustic fibers that are inherently fire-resistant. The interaction between Snowsound Fiber and air allows controlling reverberation while adjusting the environment's acoustics with precision taking advantage of installation modes, product's surface and distance from the wall. This reduces the annoying acoustic reverberation improving quality both of life and of work.



PRODUCT: FIBER 3 MELANGE



PRODUCT: FIBER 6 VELVET



PRODUCT: FIBER 6 VELVET



PRODUCT: FIBER 3 MELANGE

## The Collection



Fiber 1 Color



Fiber 2 Line



Fiber 2R Line-R



Fiber 3 Melange



Fiber 6 Velvet



Fiber 8 Bouclé



PRODUCT: FIBER 3 MELANGE



PRODUCT: FIBER 3 MELANGE, FIBER 2 LINE



PRODUCT: FIBER 1 COLOR



PRODUCT: FIBER 2 LINE



# Office & Workplace



PRODUCT: FLAP



PRODUCT: BLADE



PRODUCT: FLAP & SNOWFRONT



PRODUCT: BOTANICA



PRODUCT: FLAT



PRODUCT: BOTANICA



PRODUCT: FLAT



PRODUCT: CLASP WALL



PRODUCT: CLASP DIVIDER



PRODUCT: BAFFLE



PRODUCT: MINIMAL



# Office & Workplace



PRODUCT: MITESCO



PRODUCT: SNOWFIX & GIOTTO WALL



PRODUCT: OVERSIZE



PRODUCT: FLAP CHANDELIER



PRODUCT: BAFFLE OVERSIZE



PRODUCT: MITESCO



PRODUCT: FLAT & FLAT TOTEM

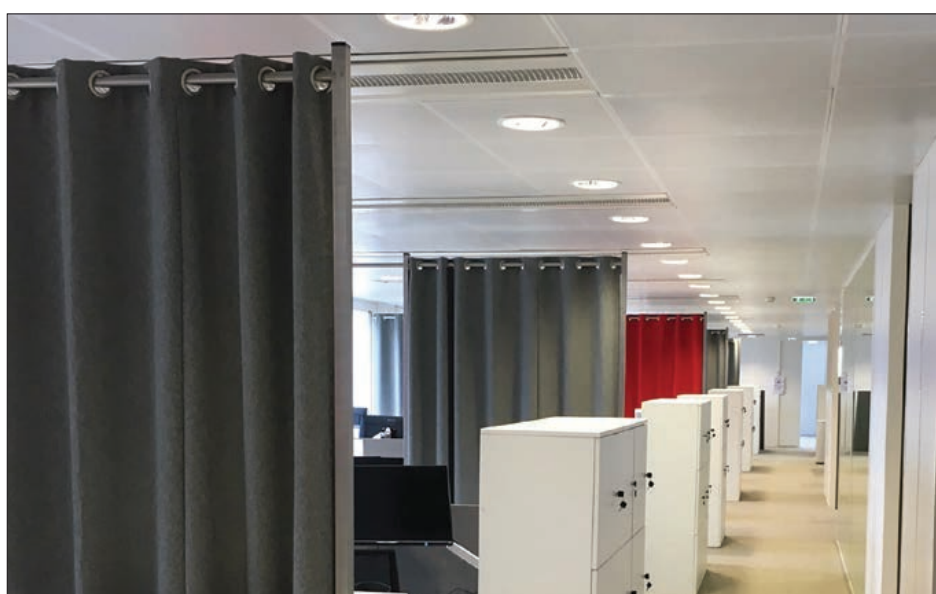

PRODUCT: SNOWSOUND FIBER 3



PRODUCT: TRA LIGHT & OVERSIZE WALL



PRODUCT: MITESCO



PRODUCT: PLI OVER



PRODUCT: FLAT

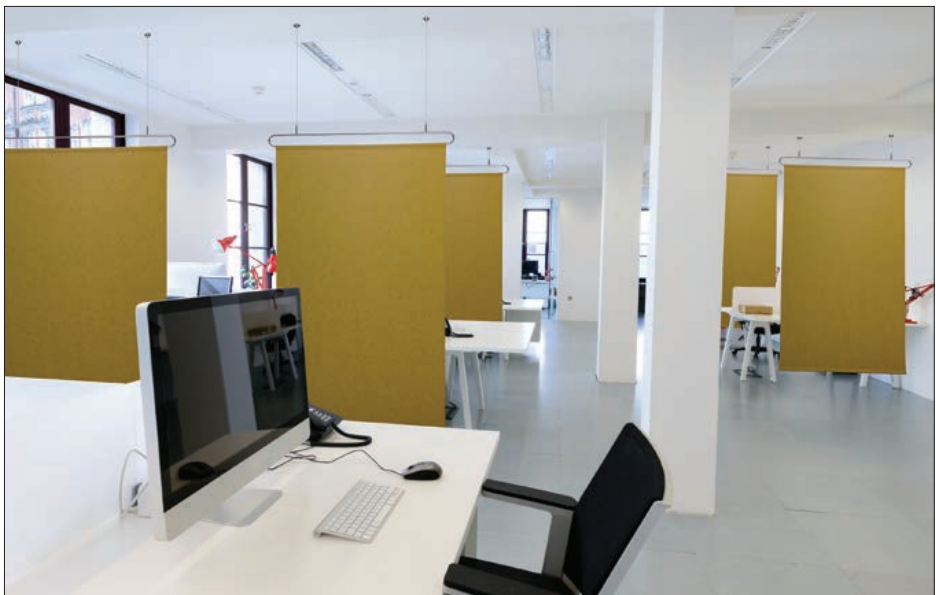

PRODUCT: CLASP CEILING



# Restaurants, Cafès & Hotels

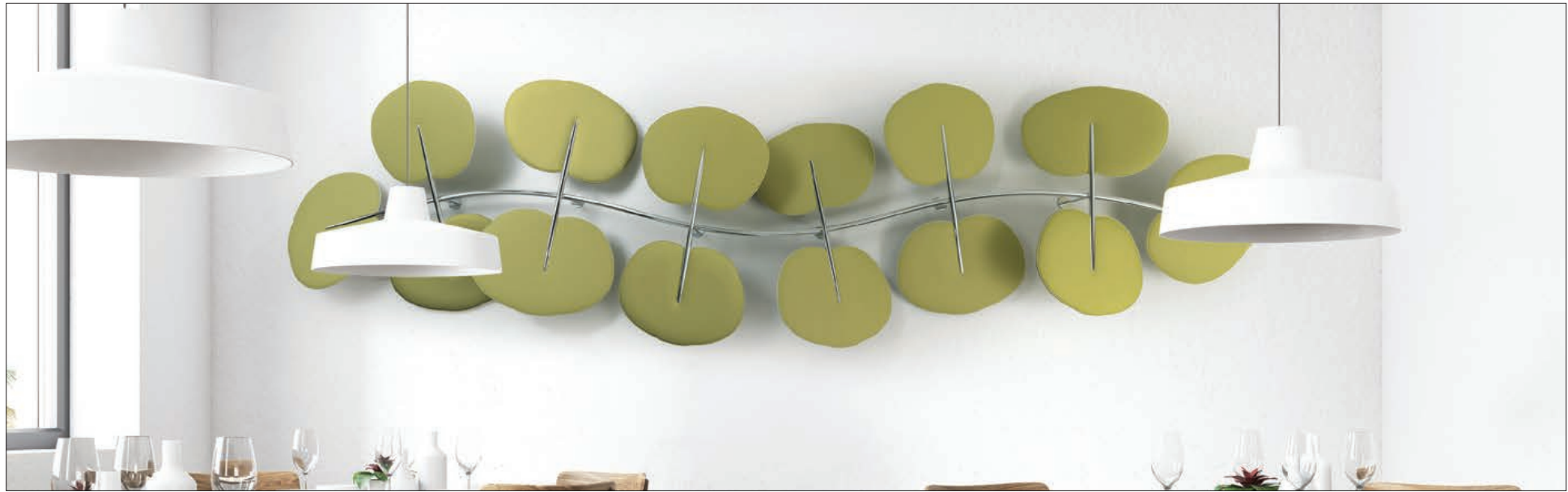

PRODUCT: BOTANICA



PRODUCT: FLAP



PRODUCT: BAFFLE



PRODUCT: BAFFLE



PRODUCT: FLAP CHANDELIER



PRODUCT: BAFFLE



PRODUCT: FLAP CHANDELIER



PRODUCT: DIESIS



PRODUCT: OVERSIZE WALL



PRODUCT: SI SBOCCIA



PRODUCT: MITESCO



# Public Spaces & Museums



PRODUCT: BAFFLE



PRODUCT: CLASP CEILING



PRODUCT: BAFFLE



PRODUCT: GIOTTO

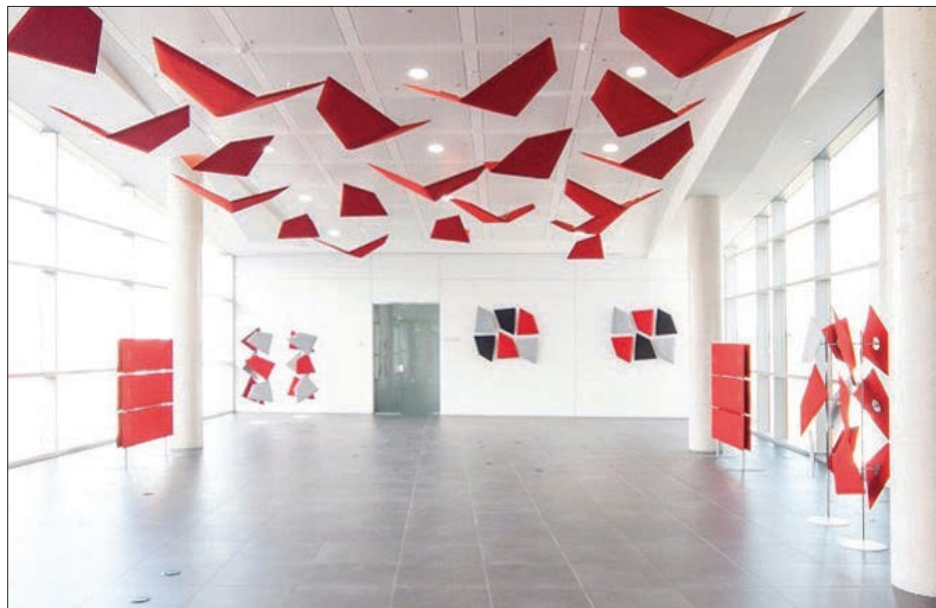

PRODUCT: FLAP, FLAP TOTEM, FLAP WINGS & MITESCO DIVIDER



PRODUCT: BAFFLE

# Education & Schools



PRODUCT: IN & MITESCO



PRODUCT: FLAP



PRODUCT: BAFFLE & FLAP



PRODUCT: FLAP & FLAP CHANDELIER



PRODUCT: IN & MITESCO



PRODUCT: MITESCO



# Retail & Leisure



PRODUCT: BEMOLLE & DIESIS



PRODUCT: FLAP



PRODUCT: MITESCO

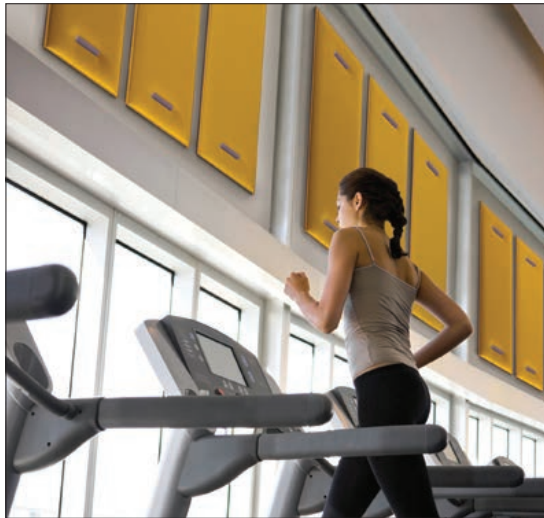

PRODUCT: MITESCO



PRODUCT: CLASP DIVIDER

# Audio & Music



PRODUCT: FLAP



PRODUCT: FLAP & MITESCO



PRODUCT: MITESCO & FIBER 3



PRODUCT: MITESCO



PRODUCT: OVERSIZE, MITESCO & FIBER 3



PRODUCT: CORISTA

# Home



PRODUCT: BOTANICA



PRODUCT: SNOWSOUND ART



PRODUCT: FLAP



PRODUCT: FLAP WINGS



PRODUCT: BOTANICA



PRODUCT: SNOWSOUND ART & SNOWFIX



# Snowsound Awards

30  
AWARDS

The technological innovations of Snowsound and the design of products made with these special technologies have achieved major world recognitions. Among other honors, in the United States Snowsound was awarded the “International CES Innovations Design and Engineering Awards,” considered the most prestigious award for innovation in the field of electronics and audio/video, the Compasso d’Oro award and the DesignEuropa Awards by EUIPO (European Union Intellectual Property Office).



# Technology

Sound is formed by waves that tend to be reflected from solid surfaces having limited absorption capacity such as, for example, concrete, marble or glass. In rooms made with these types of materials, often very annoying echoes and reverberations can be created, making it difficult to listen and converse in comfort. Sound absorbing materials are created from the need to improve acoustics in these environments. The sound absorbing characteristics of traditional products tend to demonstrate less capacity to absorb low frequencies (below 500 Hz), progressively more regarding the midrange (between 500 and 2,000 Hz) and to a greater extent with regard to the high frequencies (above 2,000 Hz).

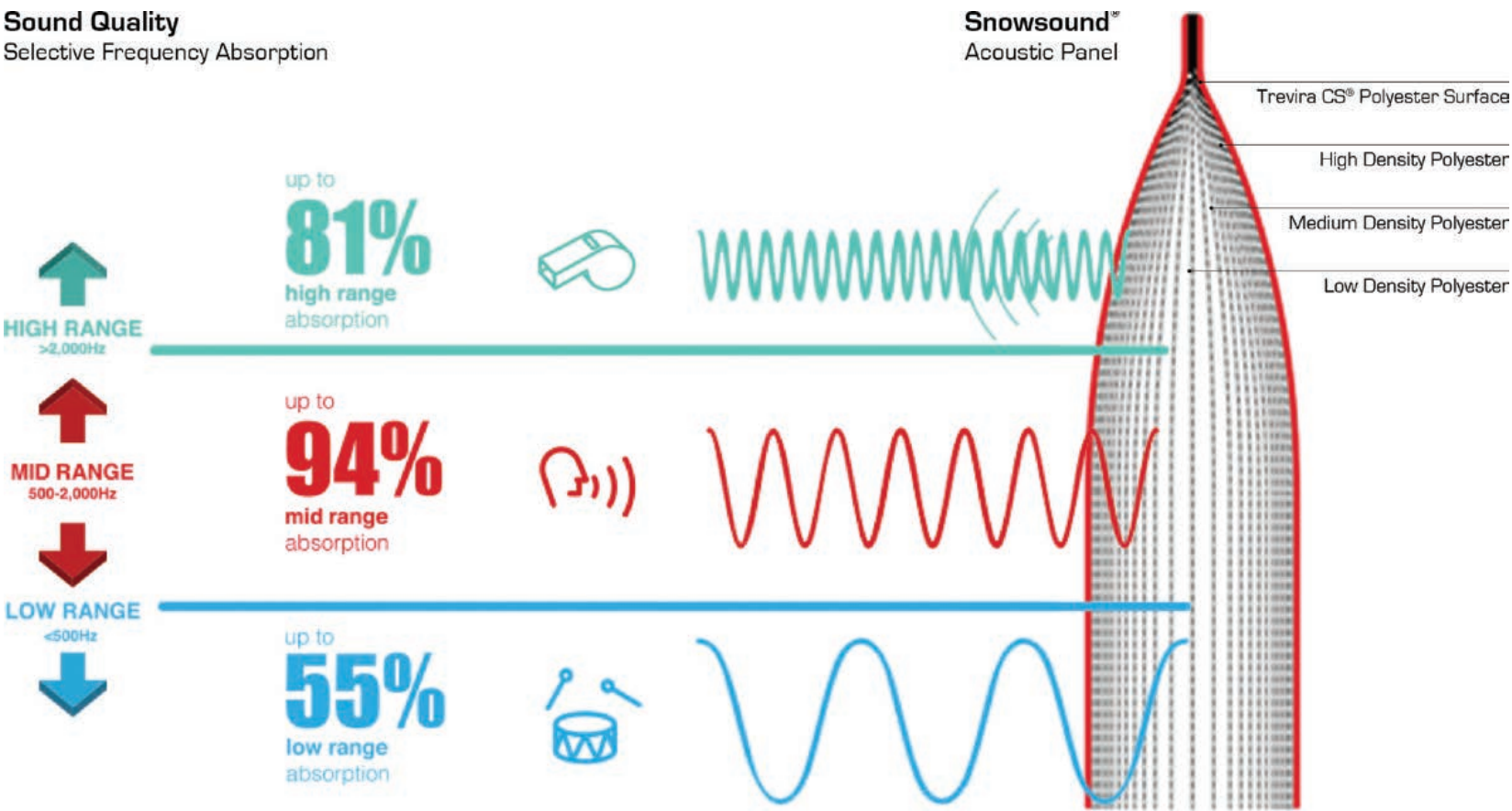

## Snowsound USA

10018 Santa Fe Springs Road  
Santa Fe Springs, CA 90670  
(562) 903-9550  
info@snowsoundusa.com  
www.snowsoundusa.com  
© 2019 Snowsound USA. All rights reserved.

## Los Angeles Showroom

8745 Washington Boulevard, Studio C,  
Culver City, CA 90232

Follow Us: @snowsoundusa



**SNOWSOUND®**  
Acoustic Technology & Design